

Packaging list

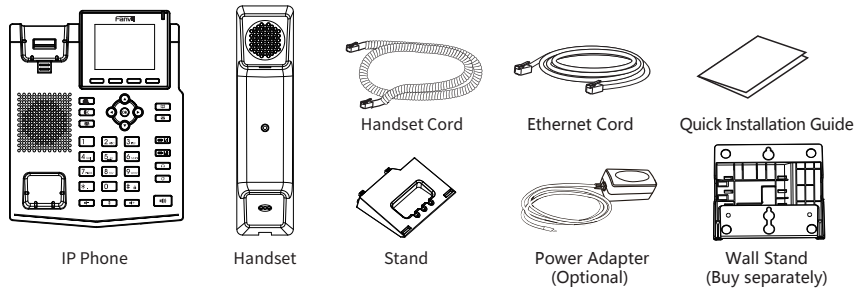

Screen icon

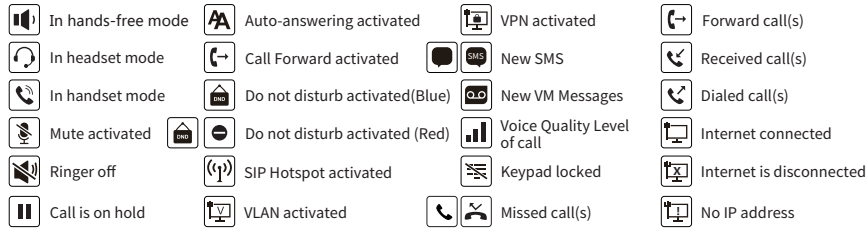

Keys features



Up navigation key, Shortcut to call log
Down navigation key, Shortcut to Status
OK key, Shortcut to Menu

Hold key, Hold/Resume the call

Call transfer key

Conference key

Phonebook key

Voice messages key



Headset key, Activate/deactivate Headset

Redial key, Access to redial the last record

In idle mode: ringer off
In communication mode: mute/un-mute a call

In idle mode or during ringing: increase or decrease ringer volume
In communication: increase or decrease earpiece, headset or hands-free volume

Hands-free key, Activate/deactivate hands free

Long press to lock keypad.
Enter PIN to unlock keypad

Installation the device

Please follow the instructions in below picture to install the device.

• Bracket desktop installation

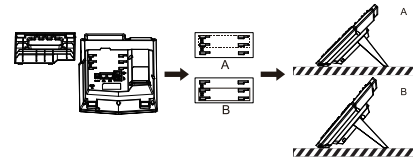

• Wall mounting (Wall Stand need buy separately)

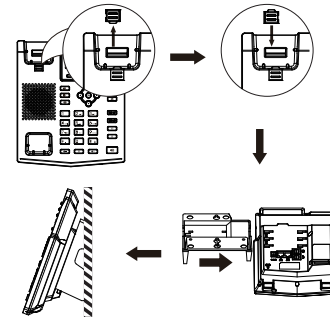

Connecting to the Device

Please connect power adapter, network, PC, headset, and headset to the corresponding ports as described in below picture.

- Power port: connect the power adapter.
- Network port: connecting local area network or Internet.
- PC port: the network port connect to the computer.
- Headset port: connect headset.
- Headset port: connect IP Phone handset.

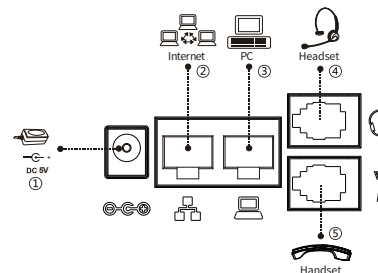

Configuration

Configuration via Phone

- Press Menu > System (Default password 123)
- Select Network: To configure the Network Settings (DHCP/Static/PPPoE)
- Select Accounts: To configure enable the account, fill the SIP server address, port, user name, password etc.

Configuration via Web

- Get the IP address from the phone: Press key, or Menu > Status > IPv4 / IPv6.
- Login: Input the IP address in the web browser. The PC and phone should be in the same IP address segment (The default username and password are both 'admin').
- Configure: Select network/Account etc, and fill the relevant content.
- Save the configuration.

Language setting

- Press Menu key > Basic > Language.
- Select the desired language and press OK soft key.

Making a call

- Pre-dialing:** enter the phone number and pick up the handset.
- Direct dialing:** lift the handset and enter the phone number.
- Handsfree:** enter phone number and press or vice versa.
- Headset:** enter phone number and press or vice versa.

Accepting a call

- With the handset:** pick up the handset.
- With a headset:** press .
- With the handsfree:** press .

Putting a call on hold

- Press key or Hold soft key, caller is put on hold.
 - To retrieve the call press key or Resume soft key.
- Note:** with more than one active call, select desired call with the navigator keys and use the corresponding soft key to hold or resume.

3-party conference

- Once in line with 1st caller, press key or Conf soft key, 1st caller is put on hold.
- Then call the 2nd number.
- After, 2nd call is established, press key or Conf soft key to set up the conference.